

SCHEMATIC FOR PMP22K30

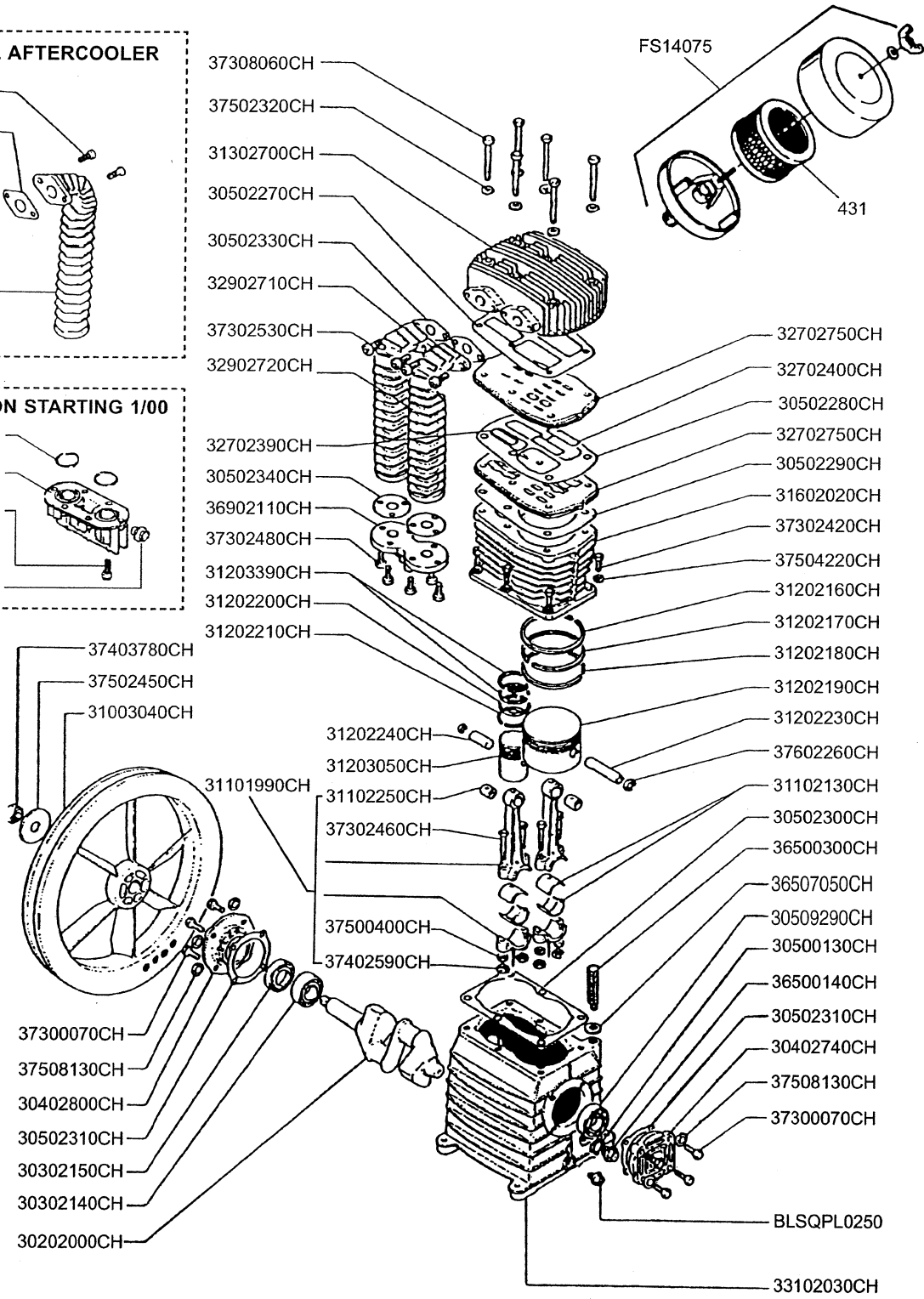

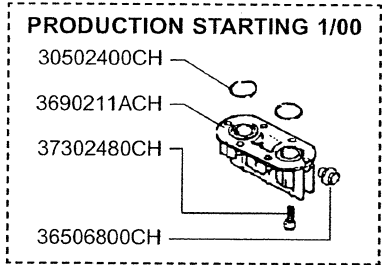
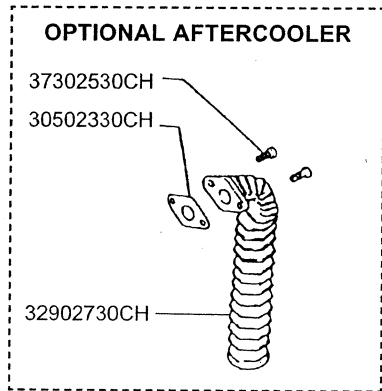

Associate Engineering Corporation

606 S. Lake Street, P.O. Box 346

Hustisford Wisconsin 53034-0346

Phone: 920-349-3281

Sales Fax: 920.349.3691 Service Fax: 920.349.8861

www.rolair.net

PARTS LIST FOR PMP22K30

Description	Part #	Qty.
Crankshaft	30202000CH	1
Ball Bearing	30302140CH	2
Oil Seal	30302150CH	1
Bearing Carrier	30402740CH	1
Bearing Carrier	30402800CH	1
Gasket	30500130CH	1
Gasket	30502270CH	1
Gasket	30502280CH	1
Gasket	30502290CH	1
Gasket	30502300CH	1
Gasket	30502310CH	2
Gasket	30502330CH	2
Gasket	30502340CH	2
O-Ring	30509290CH	1
Flywheel	31003040CH	1
Connecting Rod w/upper bushing	31101990CH	2
Bearing Shell	31102130CH	2
Bushing*	31102250CH	2
Compression Ring LP	31202160CH	1
Stepped Scraper Ring LP	31202170CH	1
Slotted Oil Ring LP	31202180CH	1
Piston LP	31202190CH	1
Stepped Scraper Ring HP	31202200CH	1
Slotted Oil Ring HP	31202210CH	1
Piston Pin LP	31202230CH	1
Piston Pin HP	31202240CH	1
Piston HP	31203050CH	1
Compression Ring HP	31203390CH	2
Cylinder Head	31302700CH	1
Cylinder	31602020CH	1
Reed Valve HP	32702390CH	2
Reed Valve LP	32702400CH	4
Valve Plate	32702750CH	2
Left Intercooler	32902710CH	1
Right Intercooler	32902720CH	1
Crankcase	33102030CH	1
Oil Sight Gauge	36500140CH	1
3/8" Breather/Oil Fill Plug w/O-Ring	36507050CH	1
Intercooler Connector	36902110CH	1
Bolt	37300070CH	8
Bolt	37302420CH	6
Connecting Rod Bolt	37302460CH	4
Bolt	37302480CH	6
Bolt	37302530CH	4
Head Bolt	37308060CH	6
Nut	37402590CH	4
Nut	37403780CH	1
Washer	37508130CH	8
Nut	37500400CH	4
Washer	37502320CH	6
Washer	37502450CH	1
Washer	37504220CH	6
Snap Ring	37602260CH	4
Filter Element	431	1
1/4" Square Head Plug	BLSQPL0250	1
Filter Assembly	FS14075	1
Ring Set	K30RINGS	1
Gasket Set	K30GASKETS	1
Valve Plate Assembly	3000VK30	1
OPTIONS: Gasket	30502330CH	1
Aftercooler	32902730CH	1
Bolt	37302530CH	2
INTERCOOLER CONNECTOR STARTING 1/00		
O-Ring – Intercooler/Connector	30502400CH	2
Plug	36506800CH	1
Intercooler Connector	3690211ACH	1
Bolt	37302480CH	6

*Bushing is not machined to fit piston pin if ordered separate from connecting rod.